



magicolor® 6100 Series Maintenance Guide

1800646-001A

Dear magicolor 6100 Series Printer User:

Thank you for purchasing a magicolor 6100 Series printer. Place this *Maintenance Guide* near the printer for quick information.

For technical support: Point your web browser to www.minolta-qms.com, and then click on 24-Hour On-line Help. The Answer Base (the dancing sun icon) helps you locate the information you need by asking you questions. You can also refer to the *Installation Guide* and the *User's Guide* for further information.



= Dispose of used consumables properly according to your local regulations. Do not dispose of them by burning.



= Keep dry



= The fuser can become extremely hot and cause severe burns. Make sure the unit is cool before handling it.

Trademarks

The following are registered trademarks of MINOLTA-QMS, Inc.: QMS, the MINOLTA-QMS logo, Crown, and magicolor.

Minolta is a trademark of Minolta Co., Ltd. Other product names mentioned in this guide may also be trademarks or registered trademarks of their respective owners.

Proprietary Statement

The digitally encoded software included with your printer is Copyrighted © 2001 by MINOLTA-QMS, Inc. All Rights Reserved. This software may not be reproduced, modified, displayed, transferred, or copied in any form or in any manner or on any media, in whole or in part, without the express written permission of MINOLTA-QMS, Inc.

Copyright Notice

This guide is Copyrighted © 2001 by MINOLTA-QMS, Inc., One Magnum Pass, Mobile, AL 36618. All Rights Reserved. This document may not be copied, in whole or part, nor transferred to any other media or language, without written permission of MINOLTA-QMS, Inc.

Notice

MINOLTA-QMS, Inc. reserves the right to make changes to this guide and to the equipment described herein without notice. Considerable effort has been made to ensure that this guide is free of inaccuracies and omissions. However, MINOLTA-QMS, Inc. makes no warranty of any kind including, but not limited to, any implied warranties of merchantability and fitness for a particular purpose with regard to this guide. MINOLTA-QMS, Inc. assumes no responsibility for, or liability for, errors contained in this guide or for incidental, special, or consequential damages arising out of the furnishing of this guide, or the use of this guide in operating the equipment, or in connection with the performance of the equipment when so operated.

Media Specifications

Media Type	Media Size		Printer Mode	Input Source ⁽¹⁾	Auto-duplex ⁽²⁾
	Inches	Millimeters			
A3	11.7 x 16.5	297.0 x 420.0	Auto. ⁽³⁾	U/L	Yes
A4	8.2 x 11.7	210.0 x 297.0	Auto.	U/A/L	Yes
A4 Transparency	8.2 x 11.7	210.0 x 297.0	Auto.	U/A	No
B4	10.1 x 14.3	257.0 x 364.0	Auto.	U/L	No
B5 (ISO) Envelope	6.9 x 9.8	176.0 x 250.0	Thick	F	No
B5 (JIS)	7.2 x 10.1	182.0 x 257.0	Auto.	U/A	No
Commercial #10 Envelope	4.1 x 9.5	105.0 x 241.3	Thick	F	No
International DL Envelope	4.3 x 8.7	110.0 x 220.0	Thick	F	No
Executive	7.3 x 10.5	184.0 x 267.0	Auto.	U	Yes
Japanese Postcard	3.9 x 5.8	100.0 x 148.0	Thick	F	No
Ledger	11.0 x 17.0	279.4 x 432.0	Auto.	U/L	Yes
Legal	8.5 x 14.0	215.9 x 355.6	Auto.	U/L	Yes
Letter	8.5 x 11.0	215.9 x 279.4	Auto.	U/A/L	Yes
Letter Transparency	8.5 x 11.0	215.9 x 279.4	Auto.	U/A	No
Overrides	13 x 19	330.2 x 482.6	Auto.	U	No
Overrides ⁽⁴⁾	13 x 18	330.2 x 457.2	Auto.	U	No
Overrides ⁽⁴⁾	12 x 18	304.8 x 457.2	Auto.	U	No
Notes	<p>(1) U = Upper universal media tray (250 sheet) A = Upper letter/A4 (optional) media tray (250 sheet) F = Media tray with optional envelope or postcard feeder L = Lower feeder unit (optional) media tray (500 sheet)</p> <p>(2) An optional duplex unit can be added to all models that have a lower feeder unit attached. Only plain paper can be autoduplexed.</p> <p>(3) Transparencies and plain paper up to 24 lb bond [90 g/m²] use the Automatic (Auto.) mode to print; other media types/weights use the Thick Stock mode.</p> <p>(4) Not available on magicolor 6100 DeskLaser.</p> <p>The single face-down output bin has a capacity of 250 sheets of 20 lb (75 g/m²) bond paper.</p>				

Loading Media

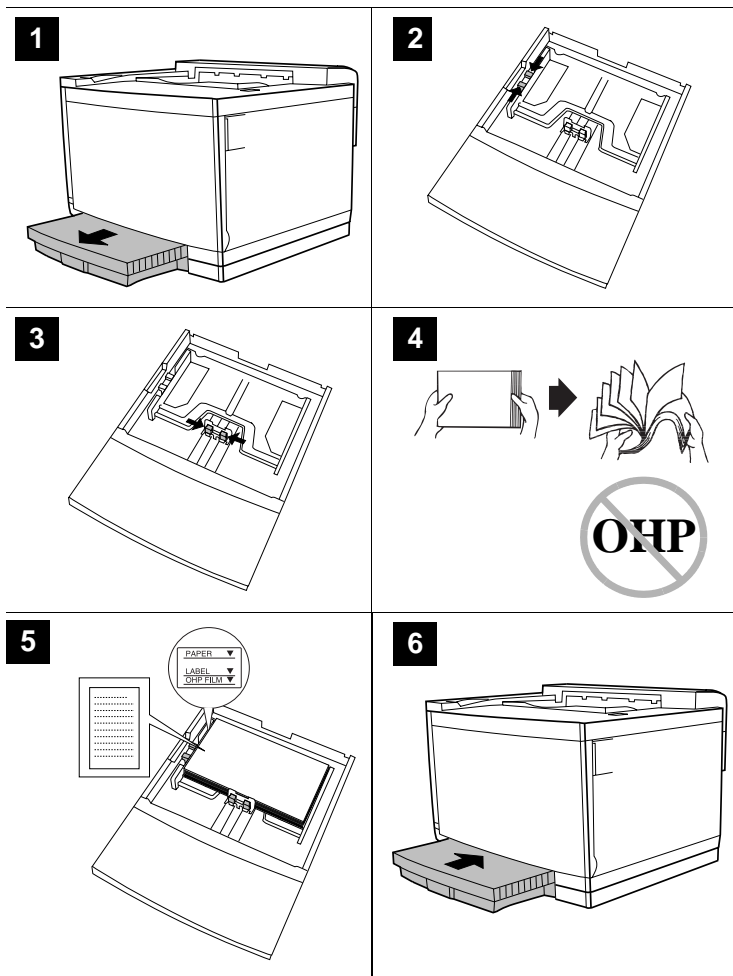

Clearing Media Jams

1

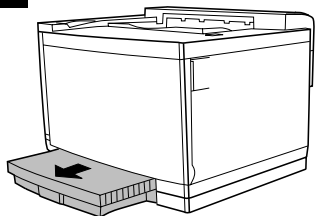

2

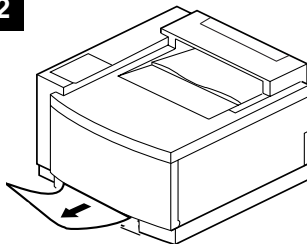

3

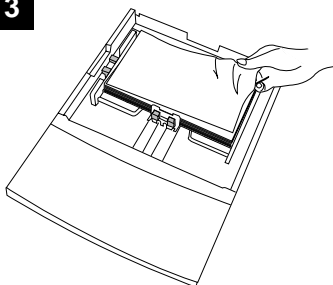

4

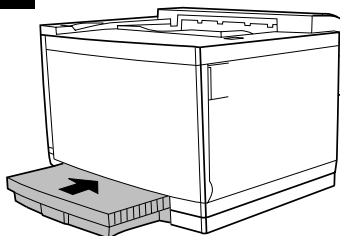

5

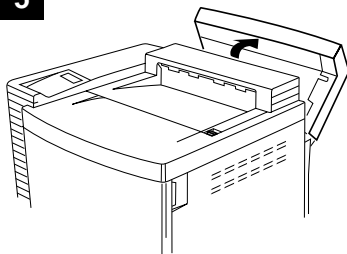

6

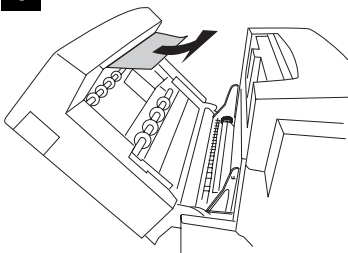

7

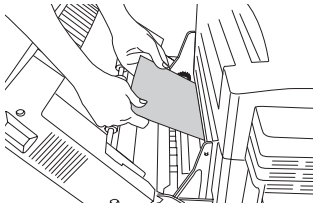

8

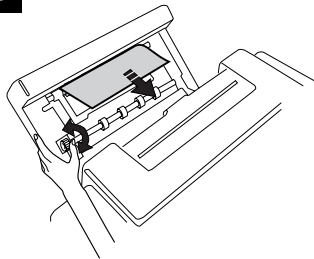

9

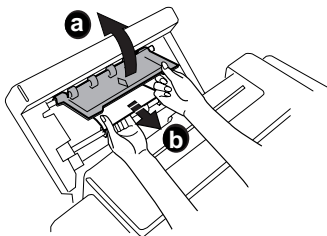

10

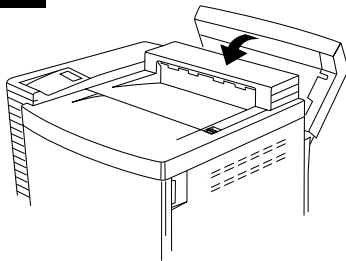

11

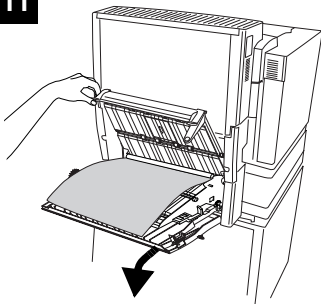

12

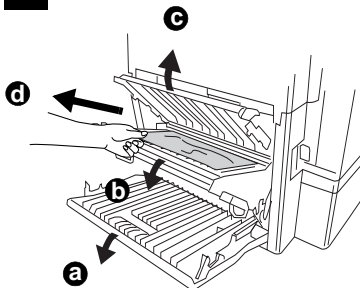

13

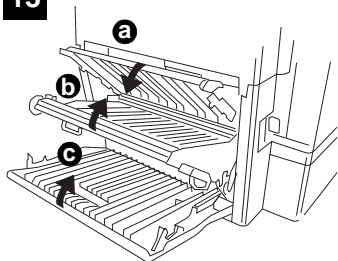

14

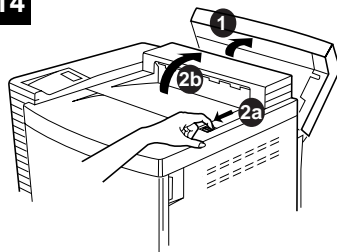

15

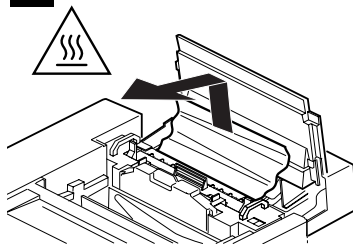

16

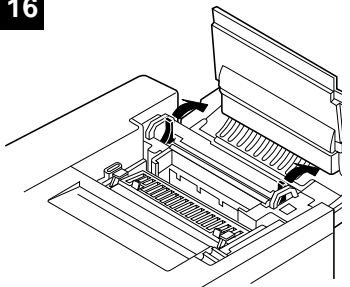

17

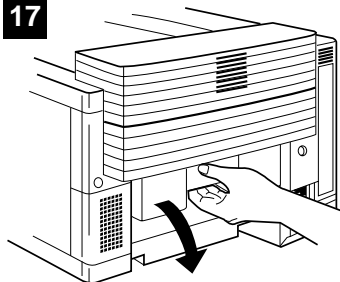

18

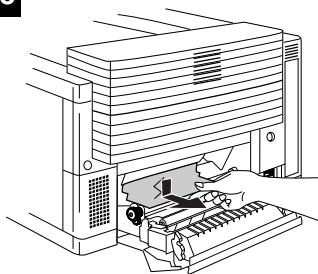

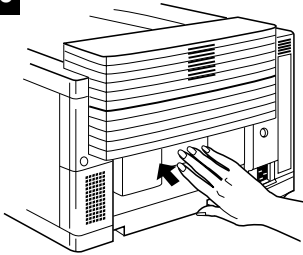
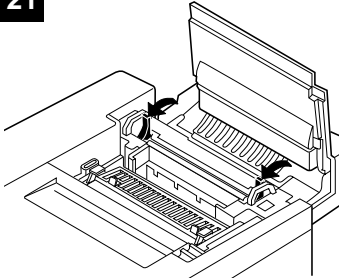
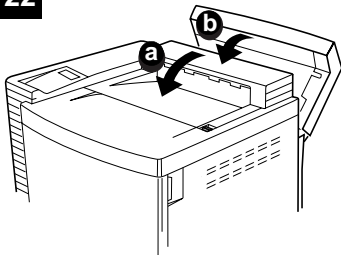
20**21****22**

Preventive Maintenance Schedule

30K MAINTENANCE	Preventive maintenance is needed after 30,000 pages have been printed.
240K MAINTENANCE	Preventive maintenance is needed after 240,000 pages have been printed.

Maintenance Schedule

Attention

Consumable life is expressed in simplex letter/A4 pages at normal 5% coverage in continuous printing. A duplex page is equivalent to two simplex pages. The stated life expectancy of each consumable is based on printing under specific operating conditions, such as ratio of color to monochrome, and media type and size. The actual life expectancy will vary (or be reduced) depending on these and other printing variables, including continuous (optimal consumable life) or intermittent (for example, one-page jobs) printing, ambient temperature, and humidity.

User replaces...	After...
Cleaning roller	20,000 pages.
Fuser oil bottle	Up to 12,000 pages. <i>Fuser oil life is media dependent. Heavy coverage, intermittent printing, and different media types can use up oil at an accelerated rate, reducing fuser oil bottle life.</i>
OPC belt cartridge	Up to 120,000 pages. <i>Other factors also affect cartridge life.</i>
Toner cartridge	Approximately 14,000 planes per black cartridge and 8,500 planes per yellow, magenta, and cyan cartridge). <i>The printer ships with an initial starter toner kit—this means the black toner cartridge has a life of 7,000 planes, while cyan, magenta, and yellow initial starter cartridges each have a life of 4,250 planes—at 5% coverage of each color.</i>
Waste toner bottle	18,000 color planes.
Ozone filter	Every 12 months.
Notes	The fusing unit, transfer drum, paper pickup roller, and paper separation pad must be replaced by a MINOLTA-QMS authorized service provider. Refer to the <i>Service & Support Guide</i> .

Error Messages



Frequent jams in any area indicate that the area should be checked, repaired, cleaned, and/or replaced. Repeated jams will also occur if you're using the wrong weight print media or if the media does not match the specifications noted in the User's Guide.

Error Message	Problem	Solution
CALL FOR SERVICE <X>	A service call is needed for <X> (the service number reference).	Place a service call for the service number reference. Refer to the <i>Service & Support Guide</i> or www.minolta-qms.com for further information.
<COLOR> TONER LOW	The indicated toner cartridge is low. There is still enough toner for approximately 100 letter/A4 planes (at 5% coverage) before the printer stops.	If print quality is reduced, redistribute the toner in the cartridge, or replace the cartridge.
<COLOR> TONER EMPTY	The indicated toner cartridge is empty.	Replace the toner cartridge.
ENERGY SAVER	Energy Saver has been activated.	No action needed.
MEDIA MISMATCH	The media detected in the tray doesn't match the media size setting.	Change the media in the tray or change the media size setting.
OUTPUT BIN FULL	The media has exceeded the limit in the output bin.	Remove the media from the specified output bin.
PUT <X> IN <Y> BIN	Refill the specified input tray with the specified media size.	Refill the specified input tray with the specified media size.
REPLACE <X>	The specified item needs to be replaced.	Replace the specified item.
<X> DOOR OPEN	The specified door (cover) is not closed properly.	Close the door(s).
<X> EMPTY	The specified item is empty, such as the fuser oil.	Replace the specified item.

Error Message	Problem	Solution
<X> JAM	Misfeed jams occur between the upper or optional tray and the print engine. A misfeed jam may be as simple as a sheet of media not being picked, or it may be that the media was picked but not fed properly.	Locate and remove the jam.
	Duplex jams occur in the duplex area or duplex refeed area on the models with duplex units installed.	
	Fuser jams occur in the fuser area.	
	Drum jams occur in the transfer drum area.	
	Transfer jams occur in the transfer roller area. This type of jam means that the media did not make it to the paper exit area.	
	Input bin jams occur in the input bin.	
	Output bin jams occur in the output bin.	
<X> LOW	The specified item is near end of life, such as the fuser oil.	Replace the specified item.
<X> MISINSTALLED	The indicated item is not installed correctly.	Reinstall the specified item.

Replacing a Toner Cartridge

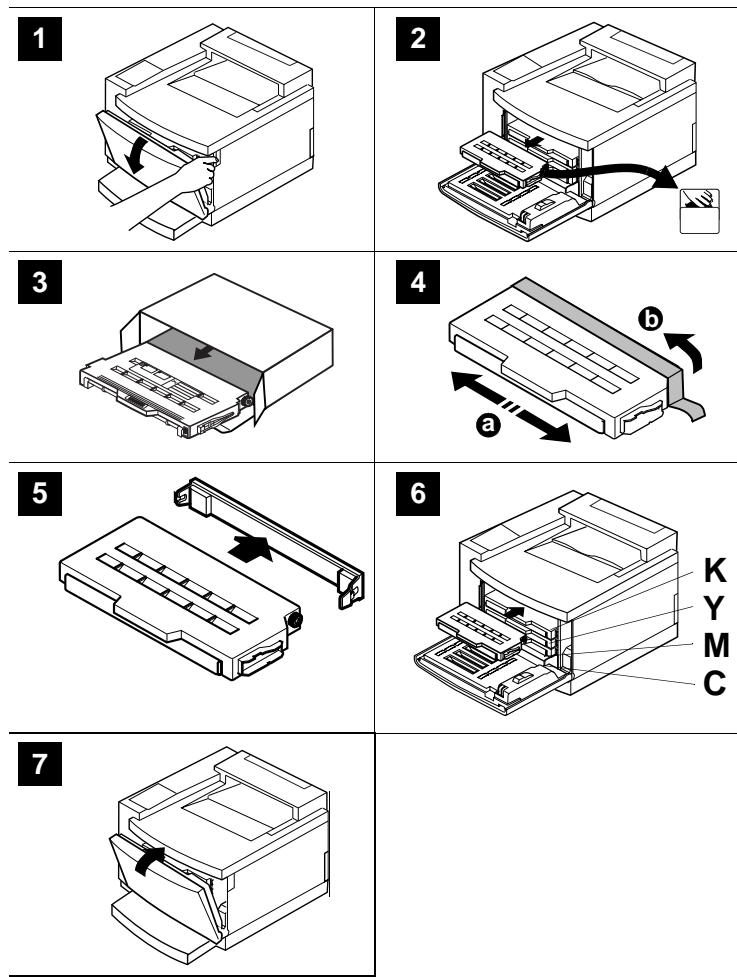

Replacing the OPC Belt Cartridge

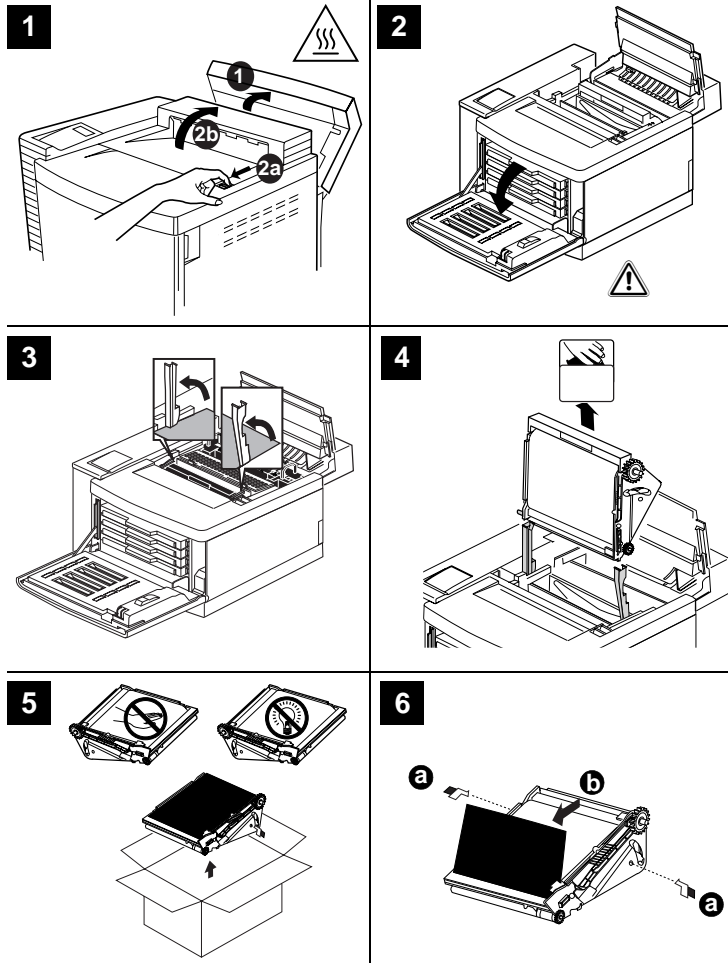

7

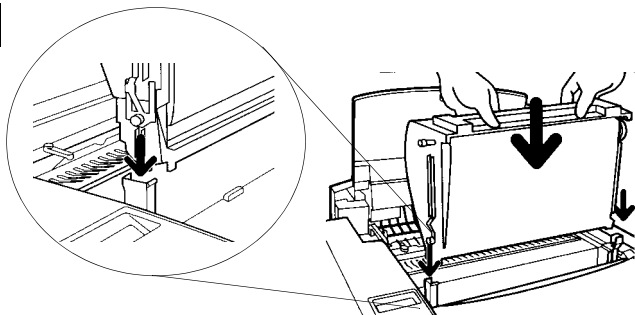

8

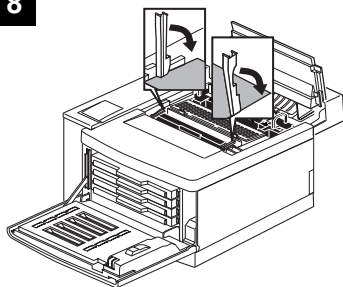

9

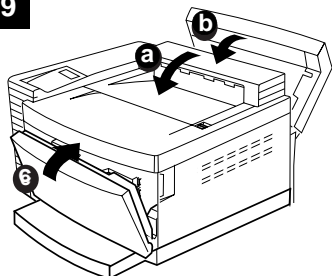

Replacing the Waste Toner Bottle

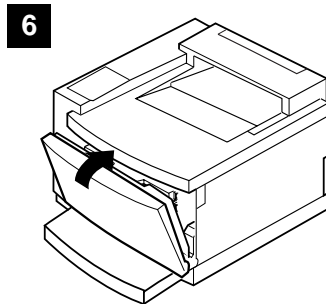
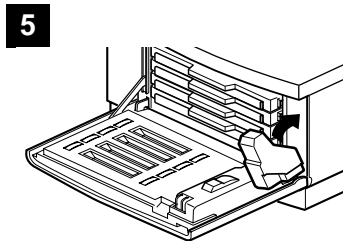
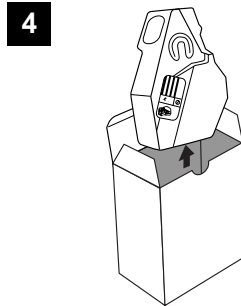
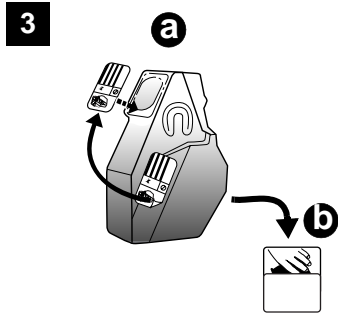
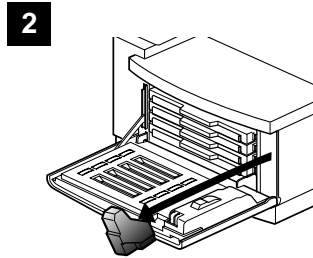
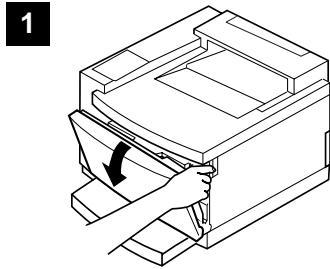

Replacing the Fuser Oil Bottle/Cleaning Roller

1

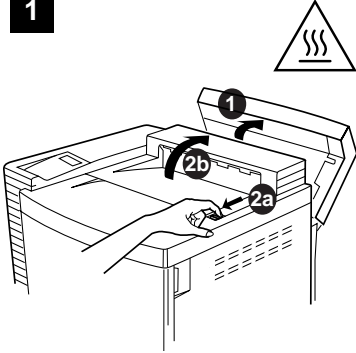

2

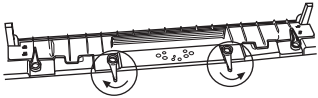

3

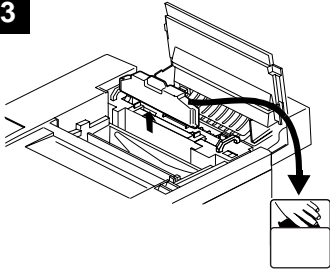

4

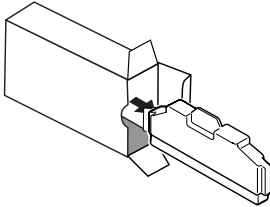

5

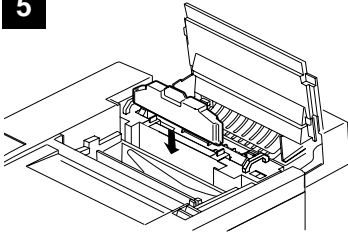

6

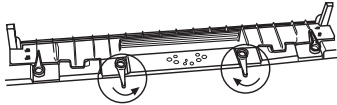

7

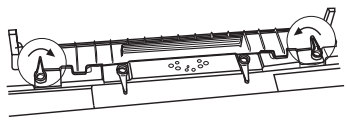

8

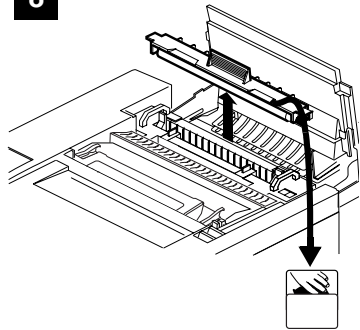

9

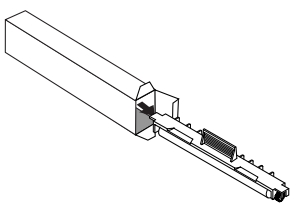

10

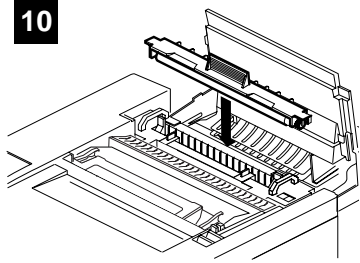

11

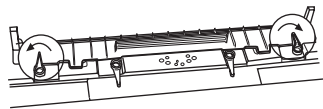

12

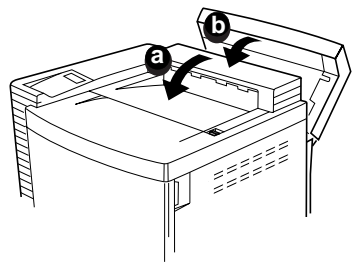

Replacing the Ozone Filter

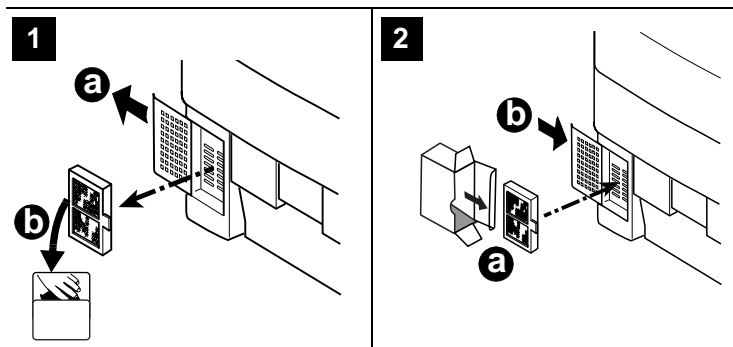

Cleaning Schedule

This item needs thorough cleaning...	After...
<ul style="list-style-type: none"> ■ Printer exterior 	As needed
<ul style="list-style-type: none"> ■ Duplex unit paper guides or rollers ■ Laser lens ■ OPC corona wire ■ Paper exit rollers ■ Printer interior ■ Transfer unit (transfer roller, registration rollers, paper discharger/wire) 	Every 30,000 single-sided pages, every 12 months, or as needed, whichever comes earlier

Cleaning

Use	Avoid
A soft dry cloth to clean the control panel	Sharp or rough implements (such as wire or plastic cleaning pads); any liquid
A soft damp cloth to clean the printer	Sharp or rough implements (such as wire or plastic cleaning pads)
Mild neutral detergent to clean the printer	Abrasive or corrosive solutions that contain solvents (such as alcohol or benzine); aerosol or pump-sprayed cleaners

Printer Exterior

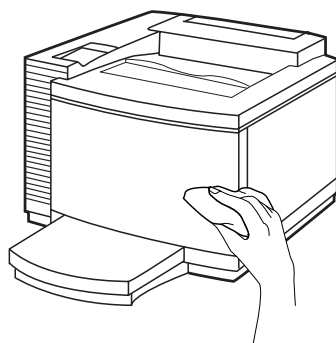
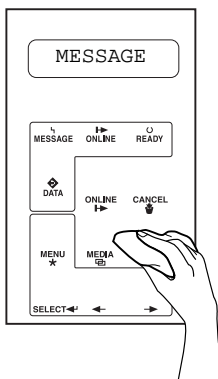

Cleaning the Transfer Unit

1

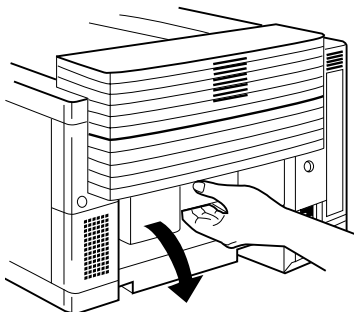

2

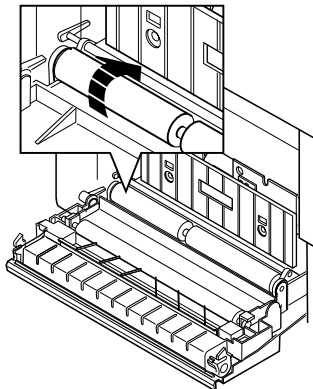

3

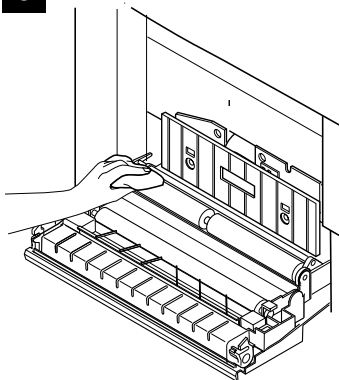

4

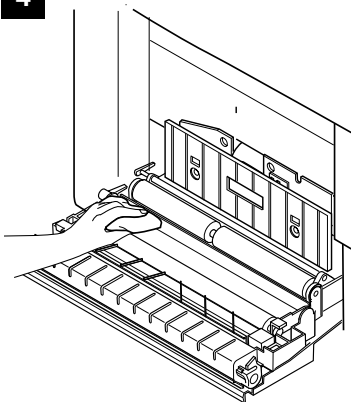

5

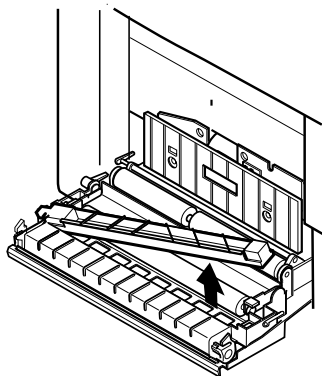

6

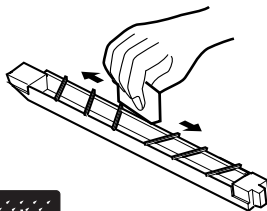

7

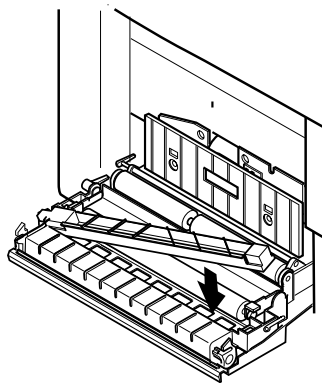

8

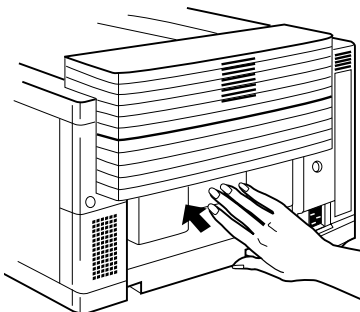

Cleaning the Laser Lens

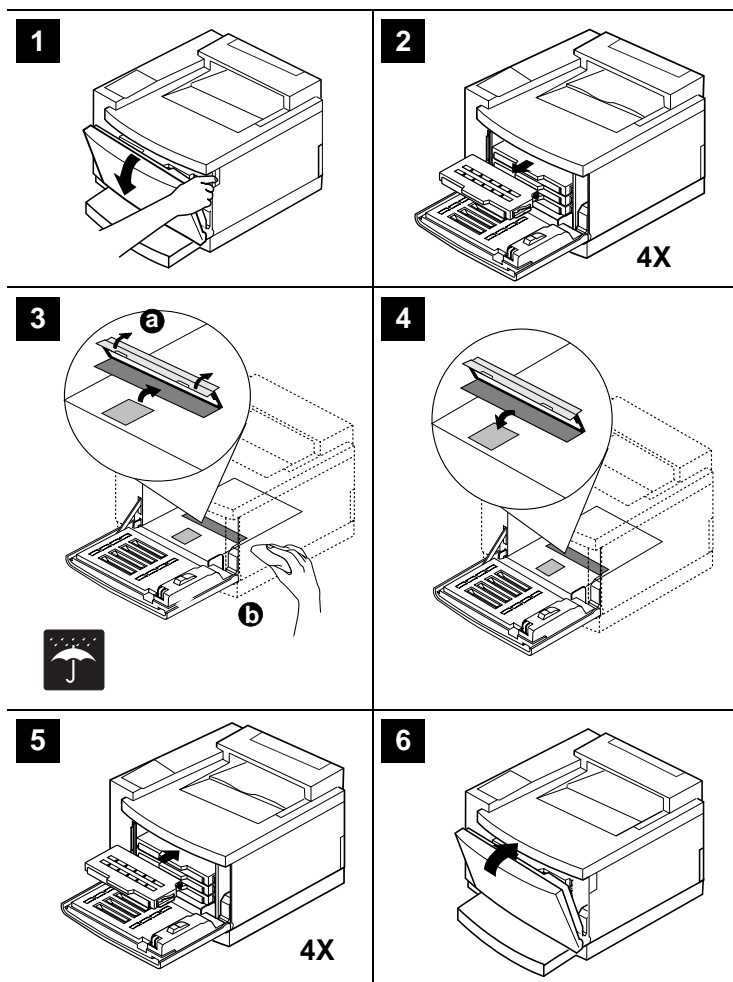

Cleaning the OPC Corona Wire

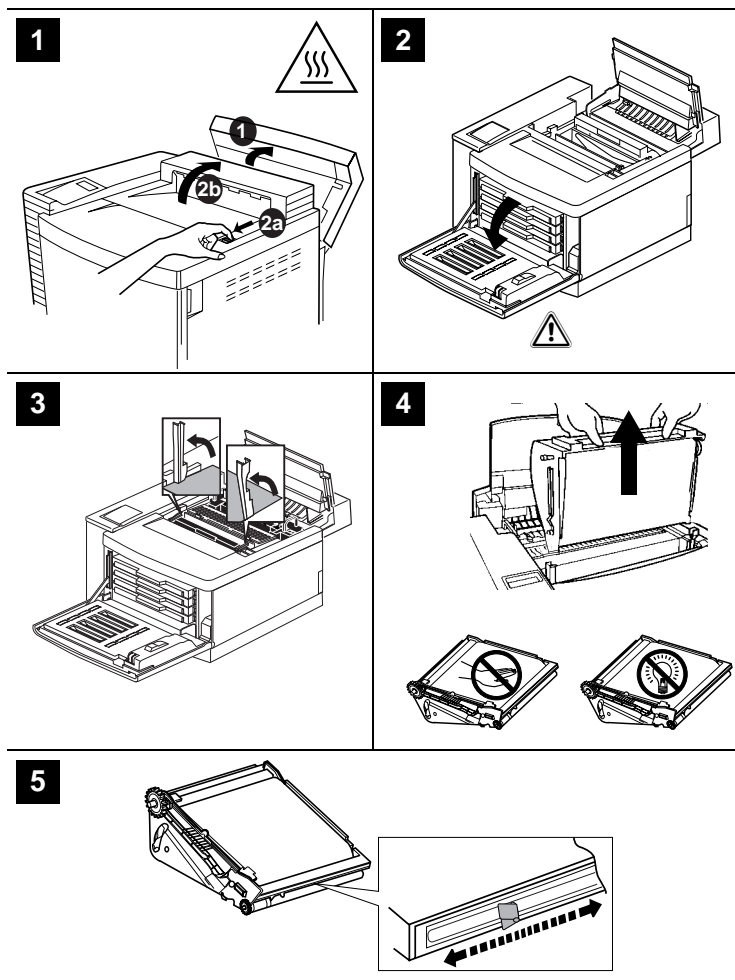

6

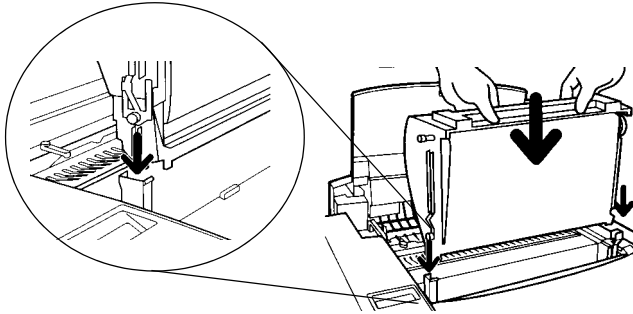

7

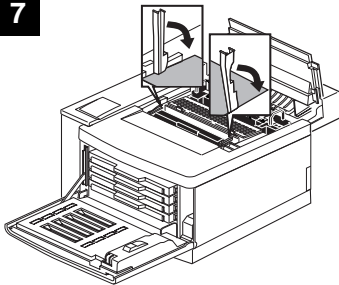

8

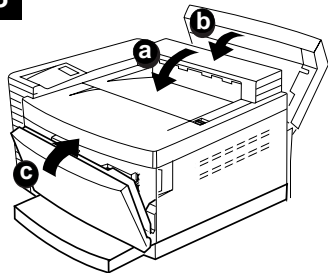

Cleaning the Paper Exit Rollers

